

Small shaped pads

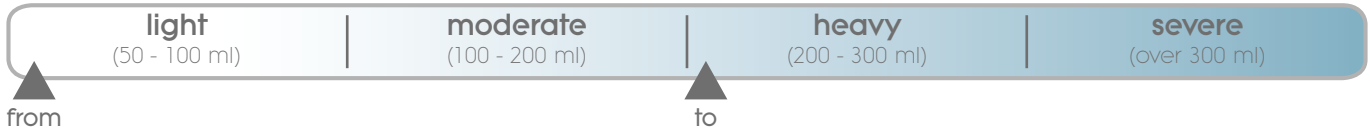

Incontinence severity (involuntary loss of urine in 4 hours)



Thinner and lighter. Hardly noticeable.

The pads for the woman and the man of today.

forma-care shaped pads woman and man active. The little ones with great performance. forma-care products will guide you safely through the day.

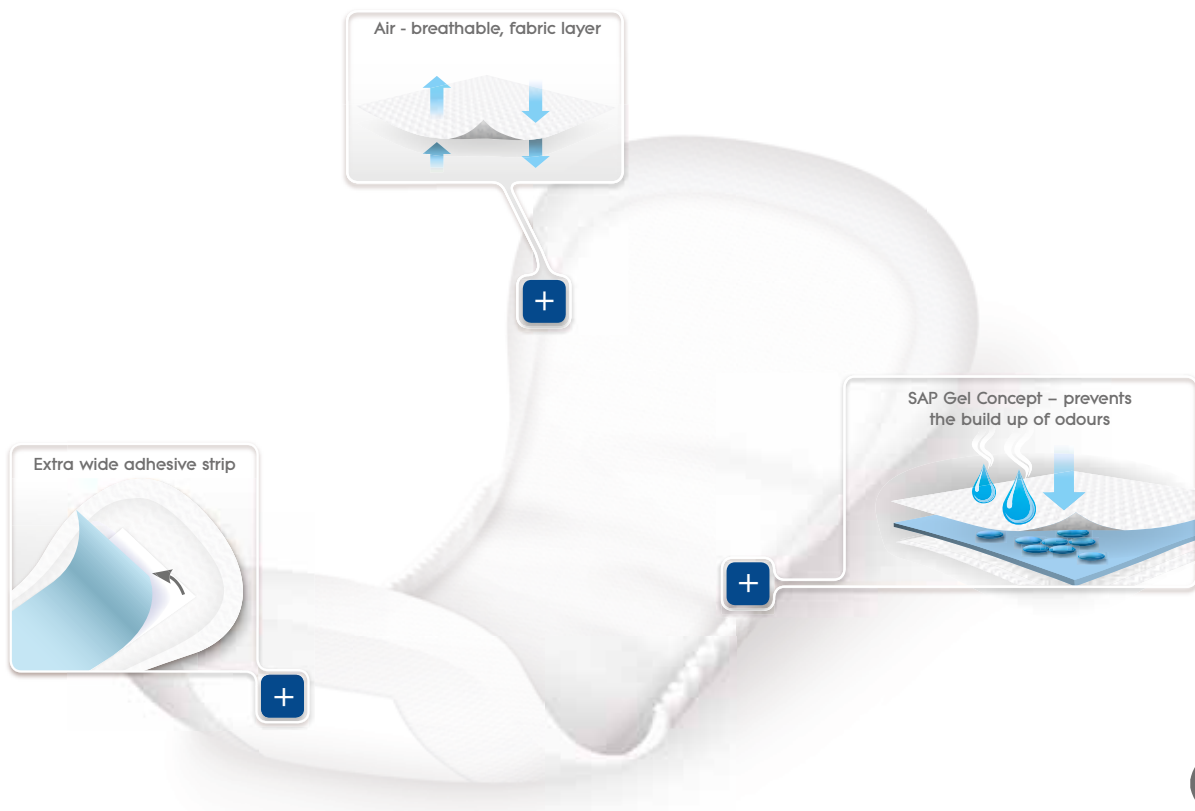

Small shaped pads



NPC	MPC	EAN code	Brand name	Colour code	Severity	Size	Weight in kg	Contents/ pack	ISO Absorbency in ml.
CFP1958	20-4031	4036978013311	forma-care woman PREMIUM - mini plus			27,5 x 11 cm	2,3	16	300
CFP1966	4040	4036978900208	forma-care woman - normal			27 x 14 cm	4,3	20	490
CFP1967	4040-01	4036978900208	forma-care woman - normal plus			27 x 14 cm	4,3	20	490
CFP1968	4045	4036978900215	forma-care woman - extra			32 x 15 cm	5	20	815
CFP1962	3010	5703538758430	forma-care man active			41,5 x 15 cm	3,4	20	980
CFP1963	3010-01	5703538758430	forma-care man active			41,5 x 15 cm	3,4	20	980
CFP1964	3010-02	5703538758430	forma-care Man active			41,5 x 15 cm	3,4	20	980
CFP1965	3010-03	5703538758430	forma-care Man active			41,5 x 15 cm	3,4	20	980



How to fit small shaped pads



Fold the product along the center of the pad into the shape of a "ship", then peel off the protective film from the insert.

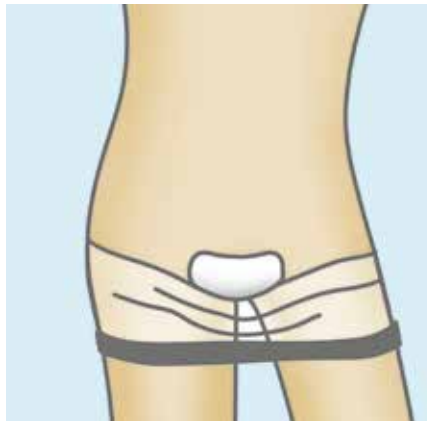

Place the insert with the adhesive side down into the underwear.



Pull up the underwear or net fixation pants to fit.

How to fit Men's Shaped Pads

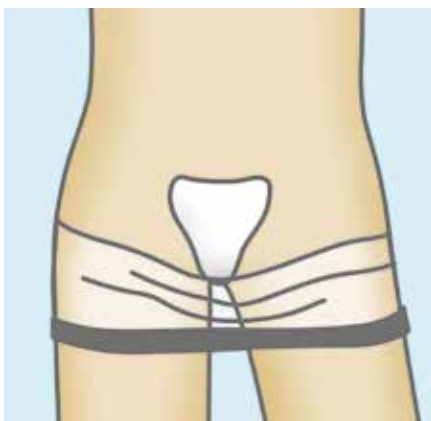

Remove the protective strip so that the adhesive surface is released.



Fold the insert lengthwise to a small ship shape. Place the penis and testicles into the insert.



Pull up the underpants or fixation pants.

User Instructions:

- Never shake or wring out the products.
- Only fold or stretch the products, if the instructions for folding the „ship“ are given.
- Do not allow contact with pointed objects when using the products – do not puncture.
- Do not work with dirty or greasy hands or when using care products. Make sure that no grease is caught on the outer layer, the adhesive strip or the inside layer of the product.